

**BWS** BEST WAY  
STONE

# STANDARD PRESS

Concrete Paver



## Installation Guide

**VB**  
VAN BEEK'S  
LANDSCAPE SUPPLY

[www.vanbeeks.com](http://www.vanbeeks.com)

# STANDARD PRESS™

CLASSIC SERIES SLAB / 45MM / 



## 24x30

23.62 x 29.52 x 1.77 in  
600 x 750 x 45 mm

IMPERIAL

METRIC

Coverage	116.22 ft <sup>2</sup>	10.8 m <sup>2</sup>
Weight	2539.7 lbs	1152 kg
Units	24	
Coverage per unit	4.84 ft <sup>2</sup>	0.45 m <sup>2</sup>
Lineal coverage	47.24 / 59.04 ft	14.4 / 18.0 m
Lineal coverage per unit	1.97 / 2.46 ft	0.6 / 0.75 m

## 16x16

15.75 x 15.75 x 1.77 in  
400 x 400 x 45 mm

IMPERIAL

METRIC

Coverage	103 ft <sup>2</sup>	9.6 m <sup>2</sup>
Weight	2070 lbs	939 kg
Units	60	
Coverage per unit	1.72 ft <sup>2</sup>	0.16 m <sup>2</sup>
Lineal coverage	78.74 ft	24 m
Lineal coverage per unit	1.31 ft	0.4 m

## 24x24

23.62 x 23.62 x 1.77 in  
600 x 600 x 45 mm

IMPERIAL

METRIC

Coverage	92.99 ft <sup>2</sup>	8.64 m <sup>2</sup>
Weight	2011.2 lbs	912 kg
Units	24	
Coverage per unit	3.87 ft <sup>2</sup>	0.36 m <sup>2</sup>
Lineal coverage	47.24 ft	14.4 m
Lineal coverage per unit	1.97 ft	0.6 m

## 12x24

11.81 x 23.62 x 1.77 in  
300 x 600 x 45 mm

IMPERIAL

METRIC

Coverage	92.98 ft <sup>2</sup>	8.64 m <sup>2</sup>
Weight	1918.5 lbs	870.24 kg
Units	48	
Coverage per unit	1.94 ft <sup>2</sup>	0.18 m <sup>2</sup>
Lineal coverage	47.24 / 94.48 ft	14.4 / 28.8 m
Lineal coverage per unit	0.98 / 1.97 ft	0.3 / 0.6 m

## COLOURS

Charcoal (24 x 24 only)

Grey (All sizes)

Red (16 x 16 & 24 x 24 only)

## NOTES

For pedestrian use only. Classic slabs do not include spacer bars. All sizes sold and packaged separately. Sold in full bundles only. The use of a plate tamper is not permitted.

When installing slabs on a pedestal set, ensure to consider load requirements. Refer to a project engineer for specific considerations.

# INSTALLATION GUIDES - SLABS & PAVERS

## SLAB INSTALLATION TYPICAL CROSS SECTION

- 1 Best Way Stone® precast concrete slab 1 3/4" to 2" (45 to 50mm)
- 2 Sand joint fill
- 3 Bedding Sand 1" (25mm)
- 4 Geotextile 12" (300mm) wide
- 5 Plastic edge
- 6 Extra width equal to foundation thickness
- 7 Lawn
- 8 Nail
- 9 Compacted aggregate base 0 3/4" (0-20mm)
- 10 Geotextile
- 11 Subgrade

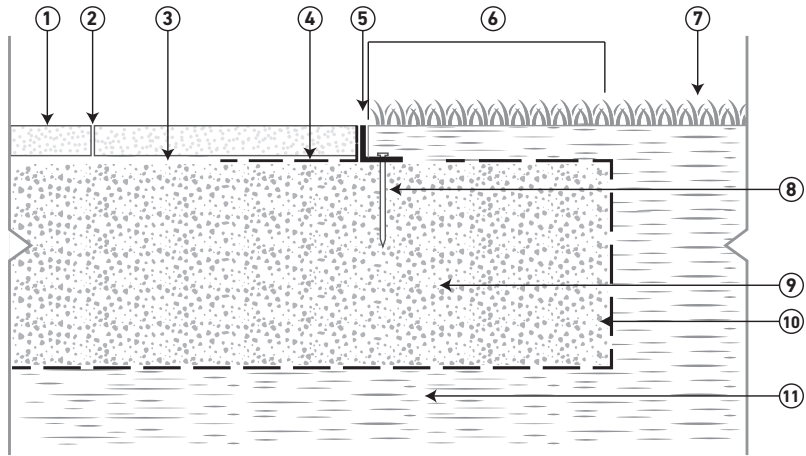

## SLABS ON PEDESTAL SET

- 1 Roof deck
- 2 Waterproof membrane
- 3 Protection board
- 4 Rigid insulation
- 5 Adjustable pedestal
- 6 Best Way Stone® precast concrete slab 1 3/4" to 2 1/2" (45-65mm) thickness conforming to ASTM C 1782 and CSA A231.1
- 7 Best Way Stone® Trevista 50 slabs, 2" (50mm) thickness conforming to ASTM C 1782 and CSA A231.1
- 8 Roof drain

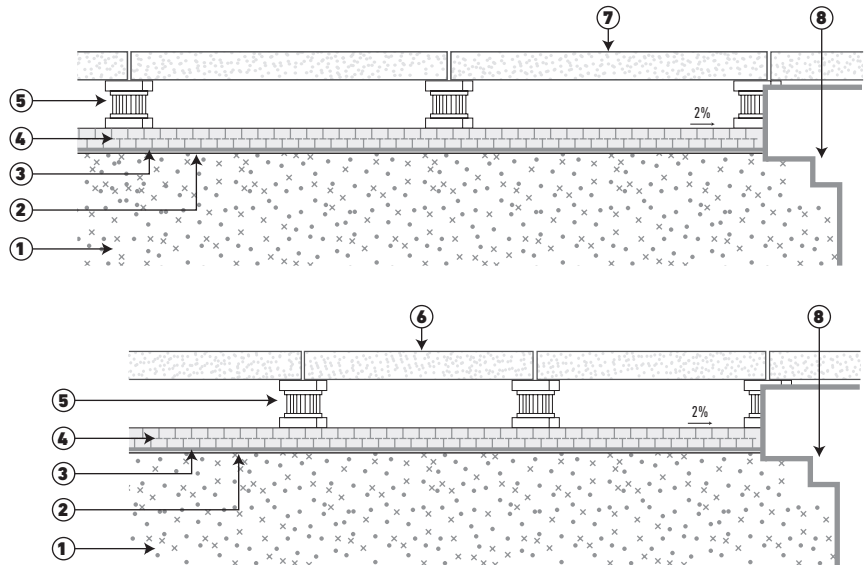

## TYPICAL PAVER CROSS SECTION WITH PLASTIC EDGE

- 1 Best Way Stone® precast concrete paver 2 3/8" (60mm) thick min.
- 2 Sand joint fill
- 3 Bedding Sand 1" (25mm)
- 4 Extra width equal to foundation thickness
- 5 Lawn
- 6 Plastic edge
- 7 Nail
- 8 Geotextile
- 9 Compacted aggregate base 0 3/4" (0-20mm)
- 10 Subgrade

